

# Parts Breakdown

Model BC-IT-0906 41317

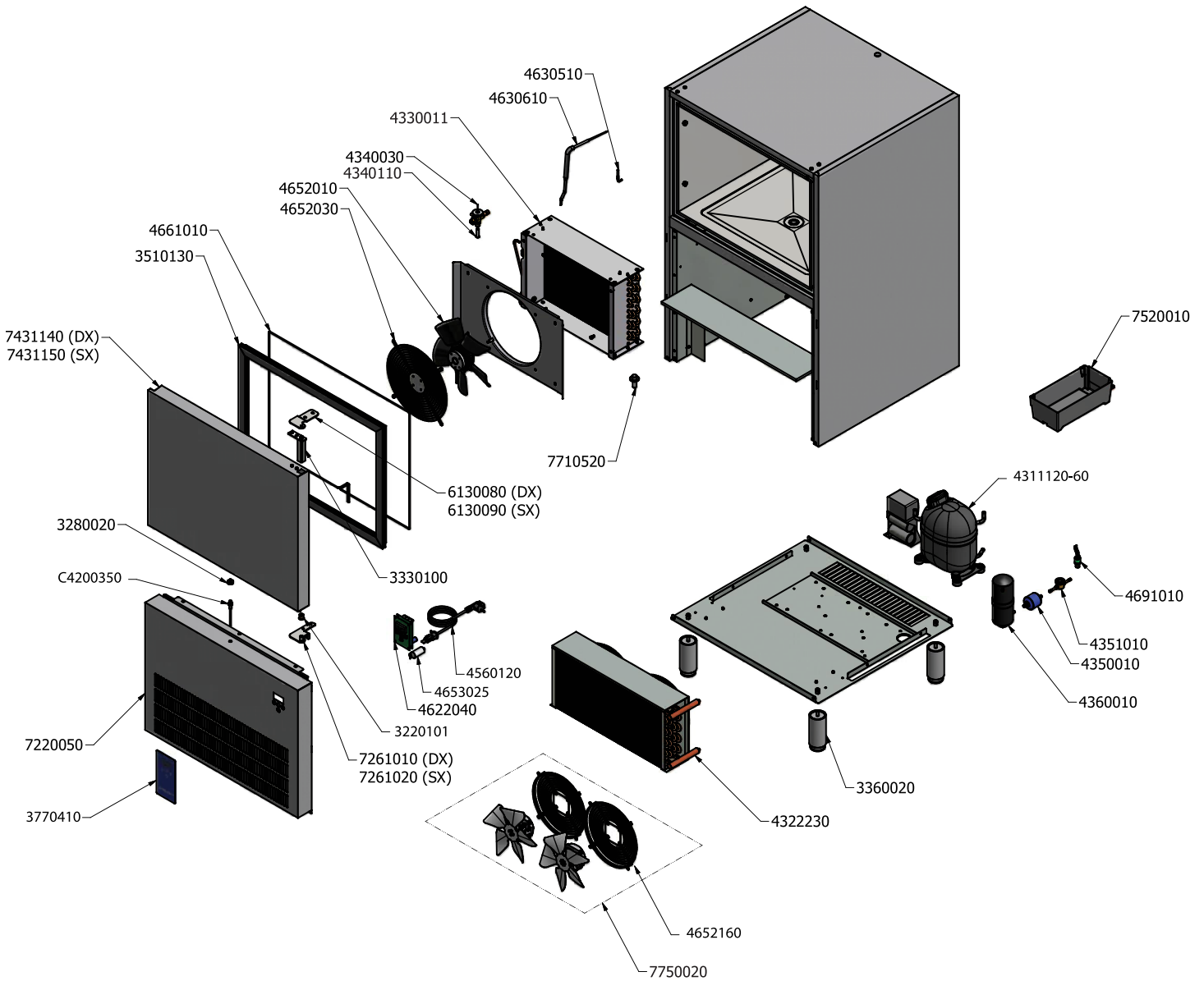

# Parts Breakdown

## Model BC-IT-0906 41317

| Item No. | Description                             | Position   | Item No. | Description   | Position | Item No. | Description                                  | Position |
|----------|---|------------|----------|---|----------|----------|--|----------|
| 42092    | Door Bush FC D13 H=2 for 41317          | 3220101    | 42103    | Filter 50x6mm for 41317                               | 4350010  | 42116    | Right Superior Hinge for 41317               | 6130080  |
| 42093    | Round Magnet D=22 for 41317             | 3280020    | 42104    | Liquid Indicator 6mm for 41317                        | 4351010  | 44035    | Left Superior Hinge for 41317                | 6130090  |
| 42094    | Door Pivot Hinge 28L S/F-13 for 41317   | 3330100    | 42105    | Liquid Receiver 0.8 LT for 41317                      | 4360010  | 42117    | Inferior Panel AB ECO-E4-06-10 for 41317     | 7220050  |
| 42095    | Feet 2' H=150 Screw M10x25 for 41317    | 3360020    | 42106    | Cable AVG SJT L=3500 UL Terminal Board PA84 for 41317 | 4560120  | 42118    | Right Inferior Hinge for 41317               | 7261010  |
| 42096    | Door Magnet Gasket AB-E4-06 for 41317   | 3510130    | 42108    | Card EVC80S11P7CLT00 AB 2RELE for 41317               | 4622040  | 44037    | Left Inferior Hinge for 41317                | 7261020  |
| 42097    | Adhesive Control Panel AB-03 for 41317  | 3770410    | 42109    | Chamber Probe PTC L=2500 Green for 41317              | 4630510  | 42119    | Foamed Door AB ECO-E4-06 DX for 41317        | 7431140  |
| 42098    | Compressor ASP NJ2192GK R404A for 41317 | 4311120-60 | 42110    | Core Probe PTC 1000 L=3000 Gray for 41317             | 4630610  | 44038    | Foamed Door AB ECO-E4-06 SX for 41317        | 7431150  |
| 42099    | Air Condenser 4R 2x250 for 41317        | 4322230    | 42112    | Stainless Steel Flat Grate ZHIEL D300 for 41317       | 4652160  | 42120    | Evaporation Water Tank 190W L=1500 for 41317 | 7520010  |
| 42100    | Evaporator AB-05 for 41317              | 4330011    | 42113    | Electric Condenser 2MF for 41317                      | 4653025  | 42121    | Water Drain Plug AB for 41317                | 7710520  |
| 42101    | Valve TES2 -40+10 R404A for 41317       | 4340030    | 42114    | Frame Heating Element AB06T 15W/M for 41317           | 4661010  | 42111    | ZHIEL Fan AB D=300 + 2COND for 41317         | 7750060  |
| 42102    | Conic Orifice 01 for 41317              | 4340110    | 42115    | Pressure Switch 28BAR for 41317                       | 4691010  | 42107    | Door Switch N.O. L=130 for 41317             | C4200350 |